

Thank you for selecting Clean products.

Before using the tester, relevant person must read and understand the contents of this operation manual. Operation Manual should be kept accessible within the person who use the testers.

TABLE OF CONTENTS

1. Product Overview	2
2. Battery and electrode installation	3
3. Configuration and LCD Introduction	3
4. Key Panel	4
5. Precautions / Maintenance	4
6. Measurement Mode	5
7. Calibration Mode	5
8. Set up	6
9. Parameters	7
10. Package	7
11. Error	8
12. General Information	8



1. Product Overview

- Precise and easy operation, Comfortable holding, all functions operated in one hand.
- Large LCD with backlight, Multi-line display for easy reading, Auto-Power Off saves battery after 5 mins non-use
- 1*1.5V AAA long battery life, User replaceable battery and high-impedance plane electrode.
- Floats on water, IP67 rated
- Field throw measurement(Auto Lock Function)
- Unit display: mg/L or %.
- Automatically compensates salinity / barometric after manual input for increased accuracy.
- User replaceable membrane cap (CS49303H1L).



Floats on water
IP67 rated



Large LCD with
backlight
Multi-line display
for easy reading



Field throw
measurement
(Auto Lock Function)



1*1.5V AAA
long battery life

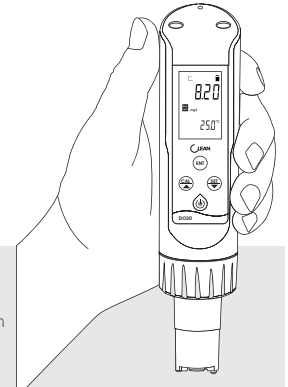

2. Battery and Electrode installation

Unscrew the screw cap by following the arrow direction, slightly unplug the electrode, install the battery (pay attention to the anode and cathode of the electrode).

Then install back the electrode and the screw cap.

Low battery prompt is at the top of the screen when battery power is low. (You can refer to the LCD INTRODUCTION). Please change the same model battery.

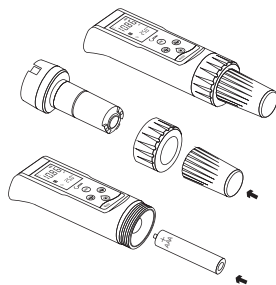

3. Configuration and LCD Introduction

- Set up
- Data stabilized
- Calibration Mode
- Low battery indicator
- Measurement mode
- Auto Lock function
- Auto Lock after data stabilized
- Sensor slope is between 50%-150%

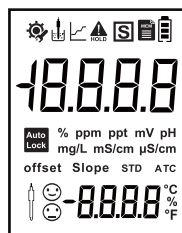

Slope The First point calibration is for saturated dissolved oxygen concentration (100% slope)

offset The Second point calibration is for Zero-Oxygen concentration calibration (0% offset)

4. Key panel

Key instruction

Short press: Short press means release the key once after pressing.

(If there is no mark out below, default it as Short press)

Long press: Long press means press the key for 3 seconds and then release it

Hold: Hold means not release the key and accelerate after a certain time. Not release the key until the value is set as needed.

	Long press to Power ON/OFF Short press to ON/OFF backlight Escape key when in calibration mode and setting up
	Calibration key when in measurement mode Long press to enter into parameter browsing Increment values or scroll through the next options available
	Data setting Decrement values or scroll through the next options available
	Confirm key Press to unlock in Auto lock mode

5. Precautions / Maintenance

- Confirm that there is no stain or breakage or wrinkles on the surface of the membrane.
- Enough electrolyte in the membrane cap.
- screw up the membrane cap slowly and softly, and make sure no bubbles on the inside membrane
- Please replace the electrolyte once every three months.

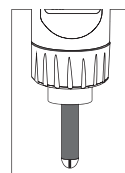

Screw down
membrane cap



Polarographic
dissolved oxygen
electrolyte

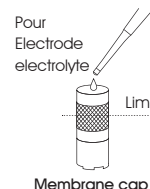

Membrane cap

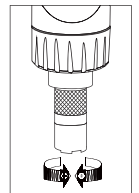

Screw up
membrane cap

6. Measurement Mode

Press "⏻" to power up. The tester will then enter into measurement mode. The measurement icon will twinkle if the data is unstabilized. Once stabilized, the top stabilized icon will be displayed then.

7. Calibration Mode

In measurement mode, press "CAL" to enter calibration mode. Prompting icons will be displayed on the screen.

The meter allows you to perform ONE point or TWO points calibration. The First point calibration is for saturated dissolved oxygen concentration (100% slope). The Second point calibration is for Zero-Oxygen concentration calibration (0% offset). Please refer to the process below:

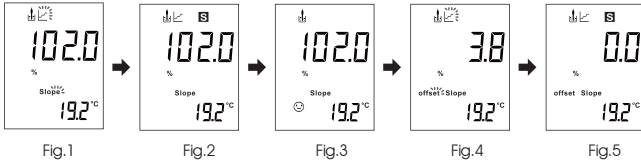

Fig.1: Expose the electrode in air. Press "CAL" key to start up the first point calibration for slope.
 Fig.2: When the reading value is stable, stabilized sign **S** appears.
 Fig.3: The ☺ smile face sign shows first point calibration completed. Then, the meter will automatically initiate the second point calibration (Fig.4). In case you don't need it, please press "⏻" key to skip it to back to measurement mode.
 The second point: zero-oxygen(0%) / offset calibration
 Fig.4: To do the second point calibration, please put the electrode into the zero-oxygen solution. The endpoint will be automatically recognized by the meter.
 Fig.5: When the stabilized sign **S** displays at the top of the screen, the second point calibration is completed. The meter will automatically go back to measurement mode.

-5-

8. Set up

In measurement mode, press "SET" to enter SET UP. Corresponding icons will be displayed. You can press "CAL" and "SET" to select the menu and then press "ENT" to confirm. Press "CAL" or "SET" to set up and confirm by press "ENT". You can also press "⏻" to back to measurement mode.

The Set up menu as follow:

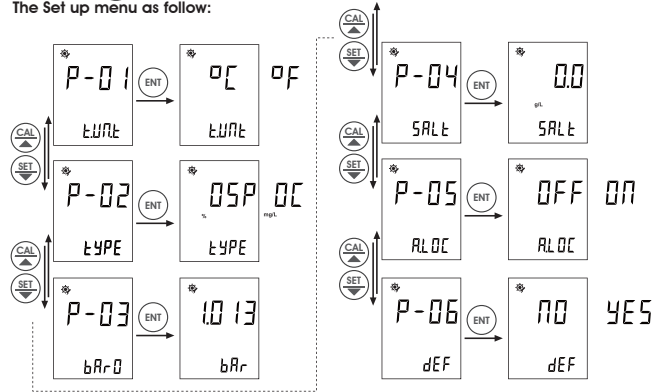

P01: Unit of the temperature. You can select between °C and °F.
 P02: Unit display: mg/L or %
 P03: Atmospheric Pressure Compensation
 P04: Salinity Compensation
 P05: Auto Lock. You can select "ON" or "OFF" to auto lock the data once stabilized.
 P06: Factory defaults. You can select to revert to factory defaults.

Long press "CAL" to browse the calibrated parameters in measurement mode.
 Press "CAL" or "SET" to check the electrode settings and the actual measurement value.

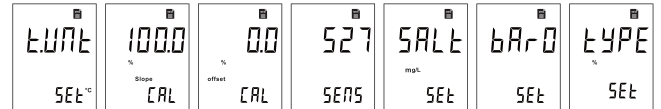

-6-

9. Specification

Range	0.00 - 20.00 ppm; 0.0 - 200.0%
Resolution	0.01 ppm ; 0.1%
Accuracy	±2% F.S.
Temp. Range	0 - 100.0 °C / 32 - 212 °F
Working Temperature	0 - 60.0 °C / 32 - 140 °F
Auto Temperature Compensation	0 - 60°C
Calibration	1 or 2 point auto calibrate (100% in air or 0% zero oxygen)
Salinity Compensation	0.0 - 40.0 ppt
Atmospheric Pressure Compensation	600 - 1100 mbar
Auto backlight off	1 minutes
Auto power off	5 minutes without key be pressed
Power	1x1.5V AAA battery
Dimensions	(H×W×D) 185×40×48 mm
Weight	95g
Protection	IP67

10. Package



Size: L*W*H 210*100*65mm
 Weight: 350g

MDO tester body
 CS4930 electrode
 1.5VAAA battery

-7-

11. Error

When ERR occurs, you can check the electrode and the standard solution.

12. General Information

Warranty

CLEAN Instruments warrants this product to be free from significant deviations in material and workmanship for a period of one year from the date of purchase. If repair is necessary and has not been the result of abuse or misuse within the warranty period, please return to CLEAN Instruments and amendment will be made without any charge. CLEAN Instruments Customer Service Center will determine if product problem is due to deviations or customer abuse. Out of warranty products will be repaired on a charge basis.

Return Of Malfunction Instruments

Authorization must be obtained from CLEAN Instruments Customer Service Center to issue a RIR number before returning items for any reason. When applying for authorization, please include date requiring the reason of return. Instruments must be carefully packed to prevent damage in shipment and insured against possible damage or loss. CLEAN Instruments will not be responsible for any damage resulting from careless or insufficient packing.

Warning: Damage as a result of inadequate packaging is the User / distributor's responsibility.

Please follow the guidelines below before transporting.

Guidelines Or Returning Unit For Repair

Use the original packaging material if possible, when transporting back the unit for repair. Otherwise wrap it with bubble pack and use a corrugated box for better protection. Include a brief description of any faults suspected for the convenience of Customer Service Center, if possible. If there are any questions, feel free to contact our Customer Service Center or distributors.

-8-